

Introduction

The YORK SOM T2 is an optic mount for (primarily) red dot sights with the Aimpoint T2 mounting screw pattern. It allows the operator to raise the *height over bore* of the red dot sight for easier weapon manipulation when using NOD's (Night Optic Devices) or (full) face masks. The *height over bore* with the YORK SOM T2 i.c.w. an Aimpoint T1/T2 is 57,5mm from the top of the NATO top rail. *Note: this can vary between different brands of optics.*

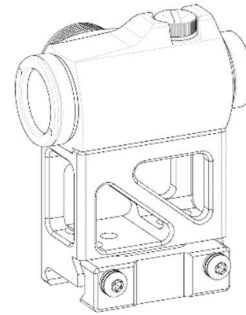

Step 1 – Check packaging

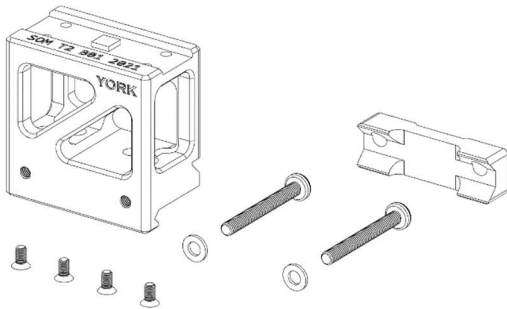

Check if all the parts are included in the packaging. You should find:

- 1x Mounting body
- 1x Clamping body
- 2x M4x35 TX20 w/ washer
- 4x M3 TX10 optic mounting screw

STEP 2 – Installation of the optic

Install your red dot sight using the M3 TX10 flat head screws: It is recommended to use thread locking compound (I.E. Blue Loctite 243), one drop on each screw.

Make sure the front of the optic is facing the same way as the YORK logo!

Don't overtighten the screws! If your particular brand of optic comes with torque specs for the mounting screws, apply them.

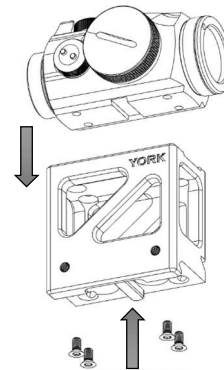

STEP 3 – Installation of mount on NATO Rail

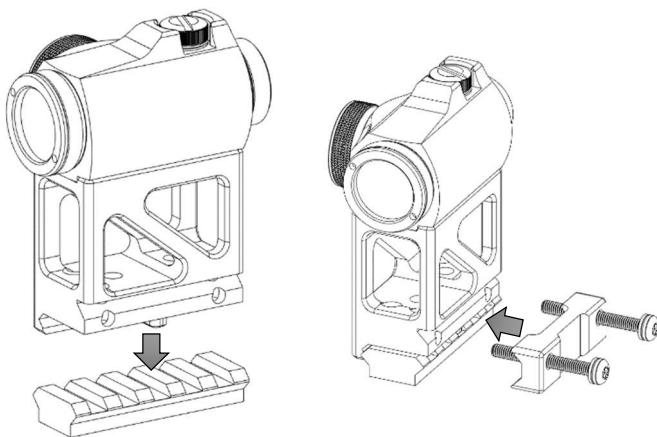

Place the YORK SOM with the optic installed on the desired position on the top rail.

- Put the recoil lug in one of the picatinny slots.
- Insert the M4x35 TX20 screws w/ washers in the clamping body.
- Insert the protruding screws in the mounting body and start turning the screws into the threads of the mounting body.
- Before tightening down the screws, press the whole mount down and forward (towards the muzzle).
- Tighten the M4x35 TX20 screws to their final torque (4 Nm is recommended).

Make sure any attachments are installed before mounting the strutted optic mount to the NATO rail.

For the best performance, it is also recommended to use thread locking compound (I.E. Blue Loctite 243), on each screw.